

USER'S MANUAL

Benutzerhandbuch

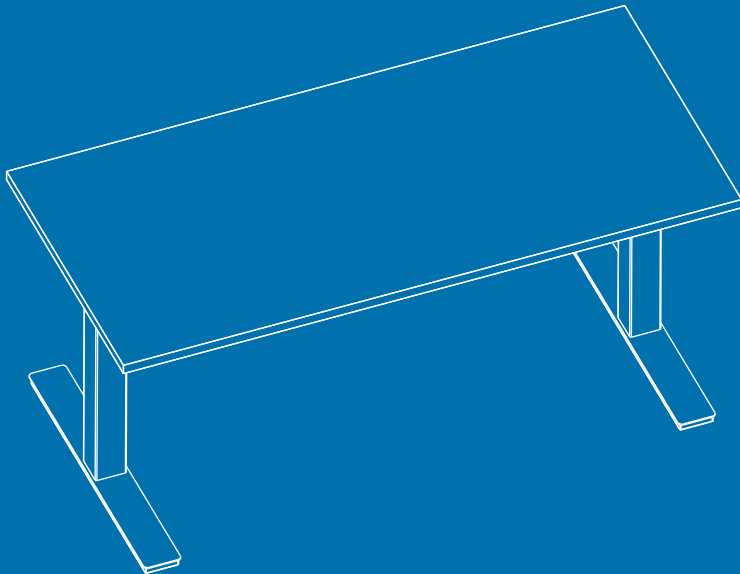

PARTS AND TOOLS LIST

NO	Name	Qty
1	Legs	2
2	Foot Pad	4
3	Foot Margin	2
4	M8*16 Screw	8
5	Bracket	2
6	M6*14 Screw	8
7	M6*10 Screw	8
8	Support Beam	1
9	4mm Hex Spanner	1
10	5mm Hex Spanner	1
11	Rubber Cushion	10
12	ST4.8*19 Screw	12
13	ST3.5*19 Screw	2
14	M6*12 Screw	8
15	M6*16 Screw	4
16	Cable Clip	5
17	Control Box	1
18	Handset	1
19	Power Cable	1

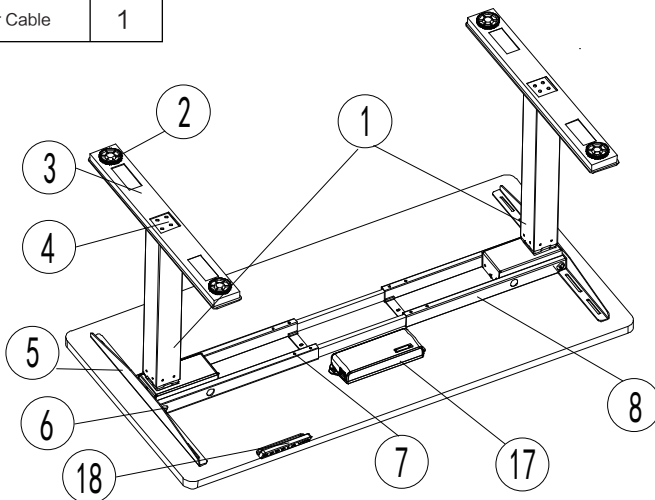
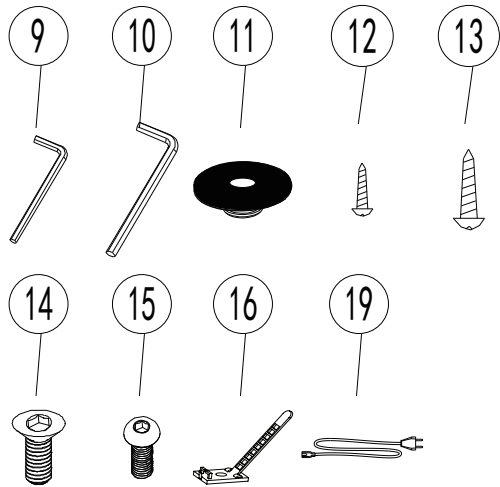

STEP 1

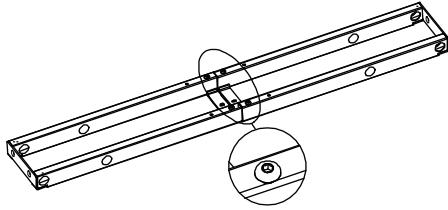

4 MM HEX SPANNER

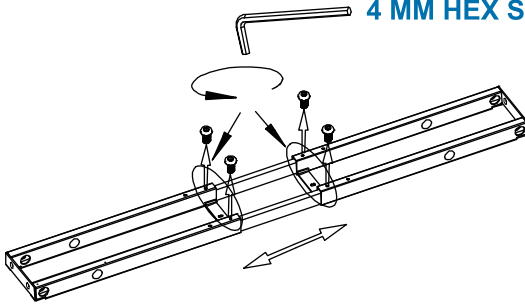

4 MM HEX SPANNER

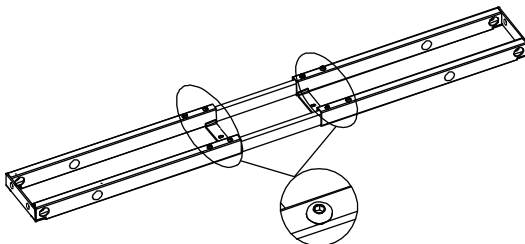
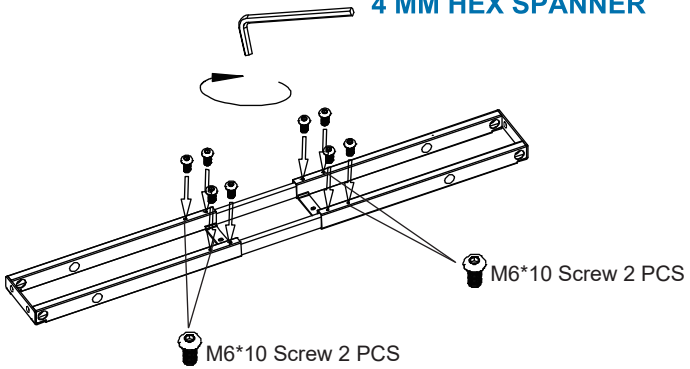

STEP 2

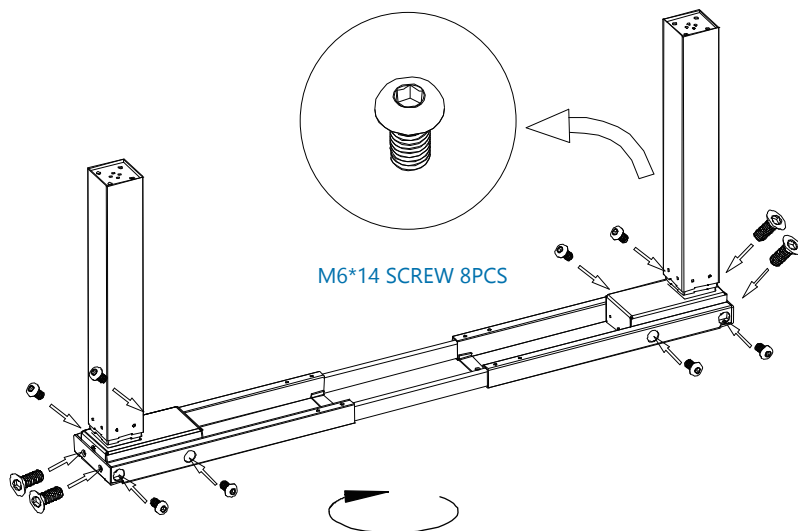

4MM HEX SPANNER

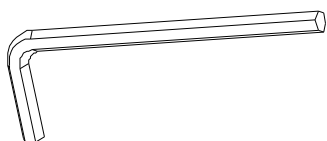

M6*12 SCREW 4PCS

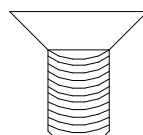

STEP 3

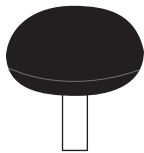
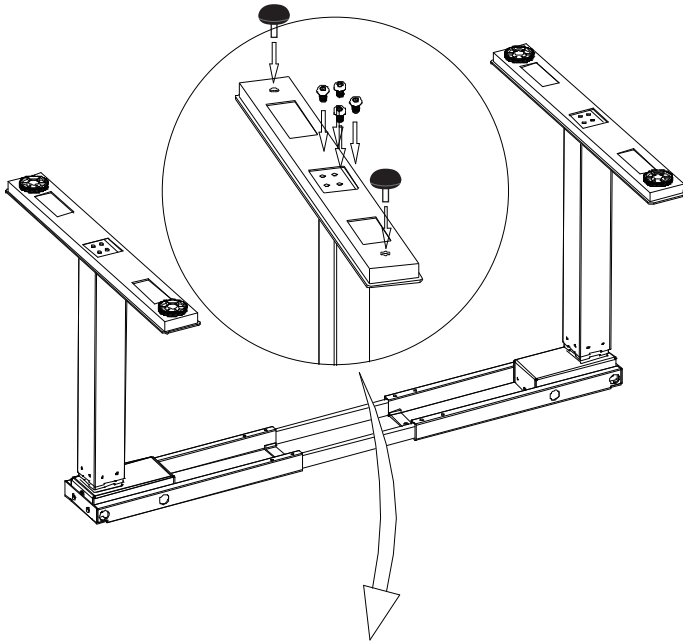

FOOT PAD 4PCS

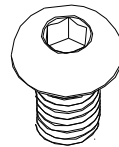

M8*16 SCREW 8PCS

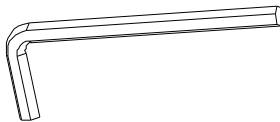

5MM HEX SPANNER

STEP 4

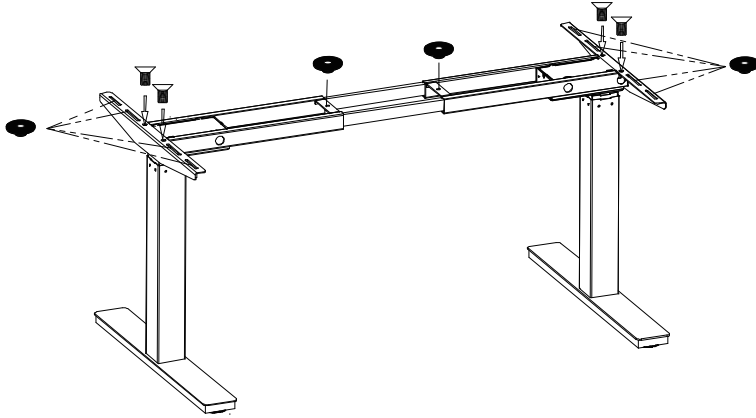

RUBBER CUSHION 10PCS



M6*12 SCREW 4PCS



4MM HEX SPANNER



STEP 5

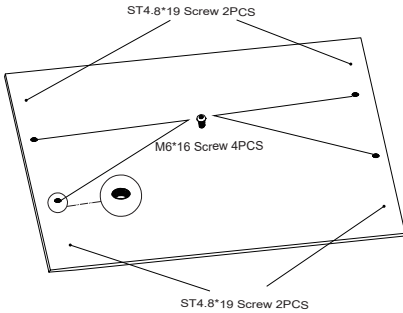
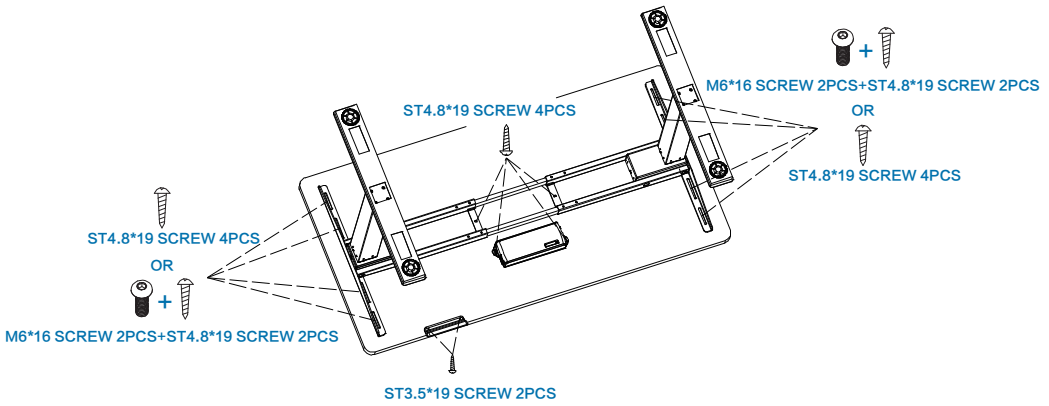

or

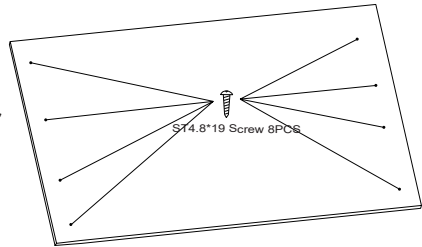

EN:DO NOT USE ST4.8*19 SCREW FOR TABLE TOP THINNER THAN 20 MM

STEP 6

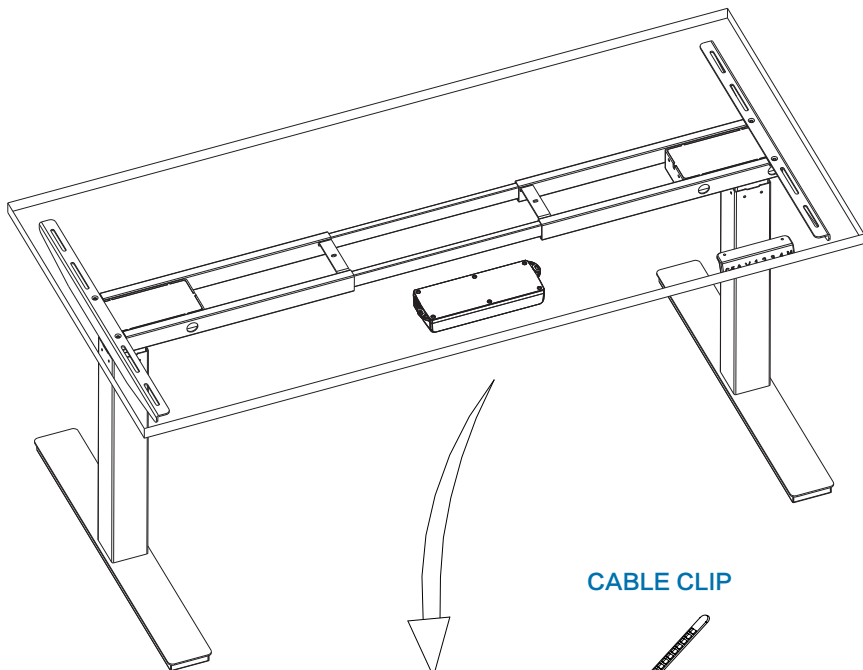

CABLE CLIP

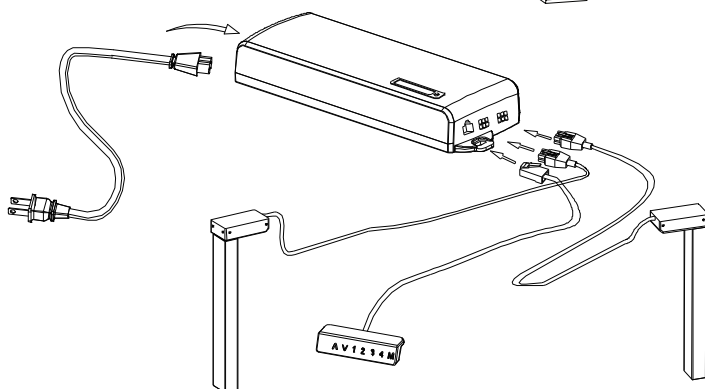

MAX.
120
KG